

# THE BURE

## THREE BEDROOM HOUSE

DETACHED: PLOTS 67, 68 & 85\*

SEMI-DETACHED: PLOTS 17, 18\*, 28, 56\*, 57, 80, 81\*, 104, 106, 131 & 132\*

TERRACED: PLOT 105

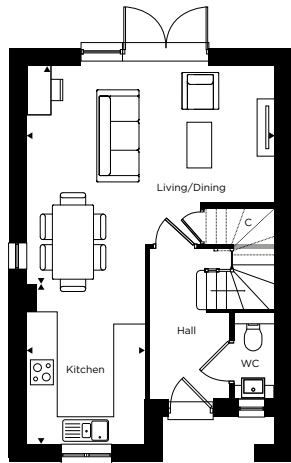

GROUND FLOOR

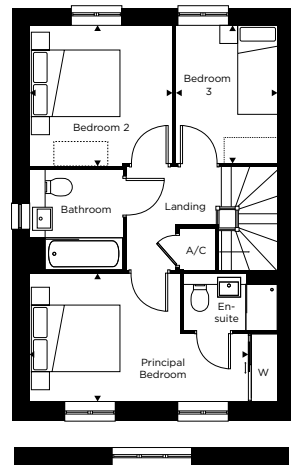

FIRST FLOOR



Exterior finishes may vary, speak to the sales team for more information. Computer generated image of plots 80 & 81 The Bure is indicative only.

### Ground Floor

Living/Dining  
5.40m x 4.80m 17'8" x 15'8"

Kitchen  
2.60m x 3.40m 8'6" x 11'1"

### First Floor

Principal Bedroom  
4.70m x 2.80m 15'5" x 9'2"

Bedroom 2  
3.05m x 3.10m 10'0" x 10'2"

Bedroom 3  
2.15m x 3.00m 7'0" x 9'10"

\*Handed to floorplan shown

\*\*Alternative single window layout to Plots 67, 68 & 85

C = Cupboard W = Wardrobe A/C = Airing Cupboard □ = Indicative wardrobe position

